

ASYMMETRICAL PULLEYS

Single Pulley Drives GF

GF
 $P_{1max.} = 45 \text{ kW}$

Asymmetrical Drive type GF, for engine power 1.1 – 45 kW consisting of:

- fixed counter pulley G (mounted on motor shaft)
- spring-loaded pulley F (is to be mounted on the machine or gear shaft)

The axial pressure of the V-belt is achieved by compression springs, the characteristic curves of which are dimensioned optimally. The rotational speed is adjusted by changing the centre distance using a motor slide. Speed adjustments possible for control range 1: 3. This system provides an almost constant power for the entire control range.

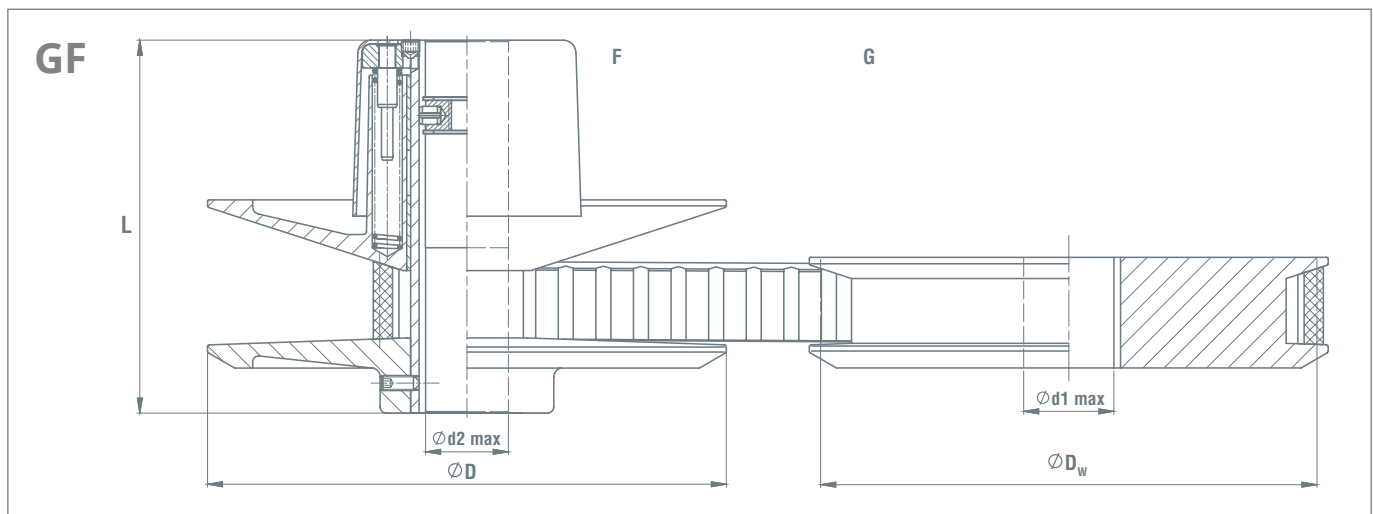

Single Pulley Drives GF

type	control range max.	motor n_1 in 1/min P_{1max} in kW		n_2 max 1/min	n_2 min 1/min	P_2 max kW	P_2 min kW	D1 mm	L1 mm	d max. mm	Dw F mm	dw F mm	Dw G mm	dimen- sions V-belt mm
GF1	2,5	1470	1,1	3570	1395	1,0	0,6	125	88	20	118	46	112	18
GF2	3,0	1470	2,2	3340	1115	2,0	1,8	175	103	24	165	55	125	27
GF2	3,0	1470	3,0	4275	1425	2,7	2,3	175	103	24	165	55	160	27
GF3	3,0	1470	2,2	2450	825	2,0	1,7	210	120	28	200	67	112	30
GF3	3,0	1470	4,0	3510	1175	3,6	3,1	210	120	28	200	67	160	30
GF4	3,0	1470	5,5	2635	880	5,0	4,00	245	150	38	234	78	140	36
GF4	3,0	1470	11,0	3770	1255	9,9	7,4	245	150	38	234	78	200	36
GF5	3,0	1470	11,0	2120	705	9,9	6,5	285	177	45	272	90	130	42
GF5	3,0	1470	15,0	4080	1350	13,5	10,0	285	177	45	272	90	250	42
GF6	3,0	1470	22,0	3340	1115	19,8	14,0	345	248	60	330	110	250	52
GF6	3,0	1470	22,0	4200	1405	19,8	18,0	345	248	60	330	110	315	52
GF7	2,5	1470	37,0	3260	1305	33,3	31,0	415	248	60	400	160	355	57
GF7	2,5	1470	45,0	3674	1470	40,5	37,0	415	248	60	400	160	400	57
GF8	2,1	1470	37,0	2600	1200	33,5	33,0	450	312	80	432	200	355	57
GF8	2,1	1470	45,0	2940	1365	40,5	39,0	450	312	80	432	200	400	57